

RESIDENTIAL PLOT PLAN DRAWING

Drawing must include:

An accurate, readable, **scaled drawing** is required showing the following:

- The shape, area and dimension of the property
- The location and dimensions of all existing and/or proposed structures to be erected, altered or moved on property
- Set backs of all existing and/or proposed structures from all lot lines and dimensions from each other
- Location of any septic system, drain field and well
- Configuration of the driveway and parking, if applicable
- Abutting roads noted
- Attach drawings including layout and elevations for new construction

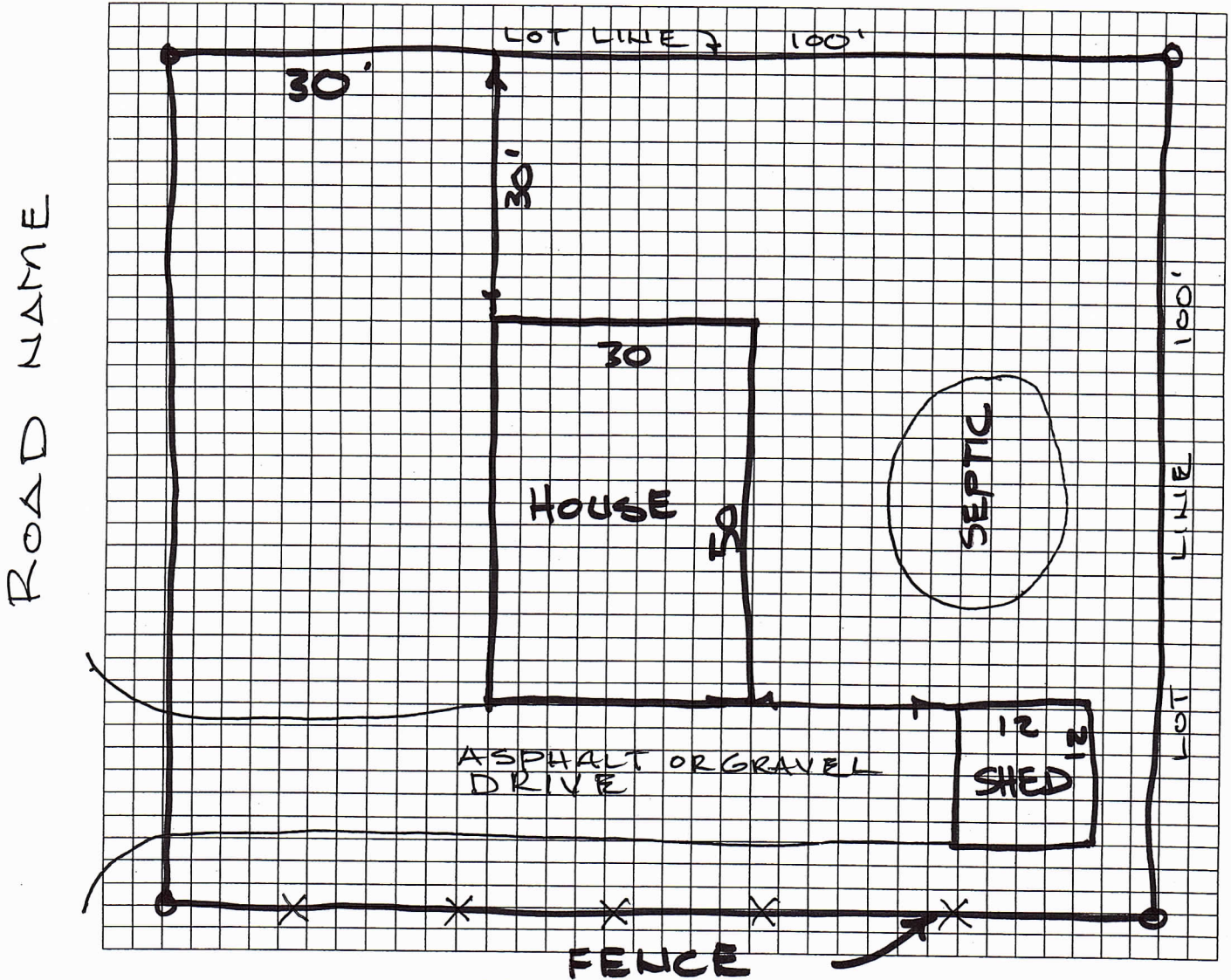
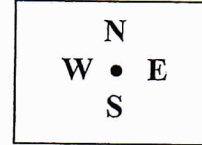

APPLICANT CERTIFICATION

"I certify the above drawing prepared above accurately reflects the subject property as surveyed including the height, size, and setback locations of proposed signs."

Signature (Applicant)

Date

Approved Zoning Administrator

Date